

मूल विकास प्राधिकरण मुद्राबंद
 समन मानचित्र सं 191/2011
 दि 17/11/10 में दि 16/11/13 तक
 स्वीकृत/मंजूरीकृत
 शमन मानचित्र की स्थिति में किसी भी
 स्वामित्व पर कोई प्रतिकूल प्रभाव नहीं
 होगा

- शर्तें:**
1. आन्तरिक विभाजन कार्य लीन वर्क में पूर्ण किया होगा।
 2. आन्तरिक विभाजन कार्य लाल रंग में मानक के अनुसार किया जाएगा।
 3. प्रस्तावित संकलन, नगर निगम में स्वीकृति के होने तक इसका पूरा-पूरा आर्किटेक्चर दस्तावेज नहीं तैयार किया जाएगा।

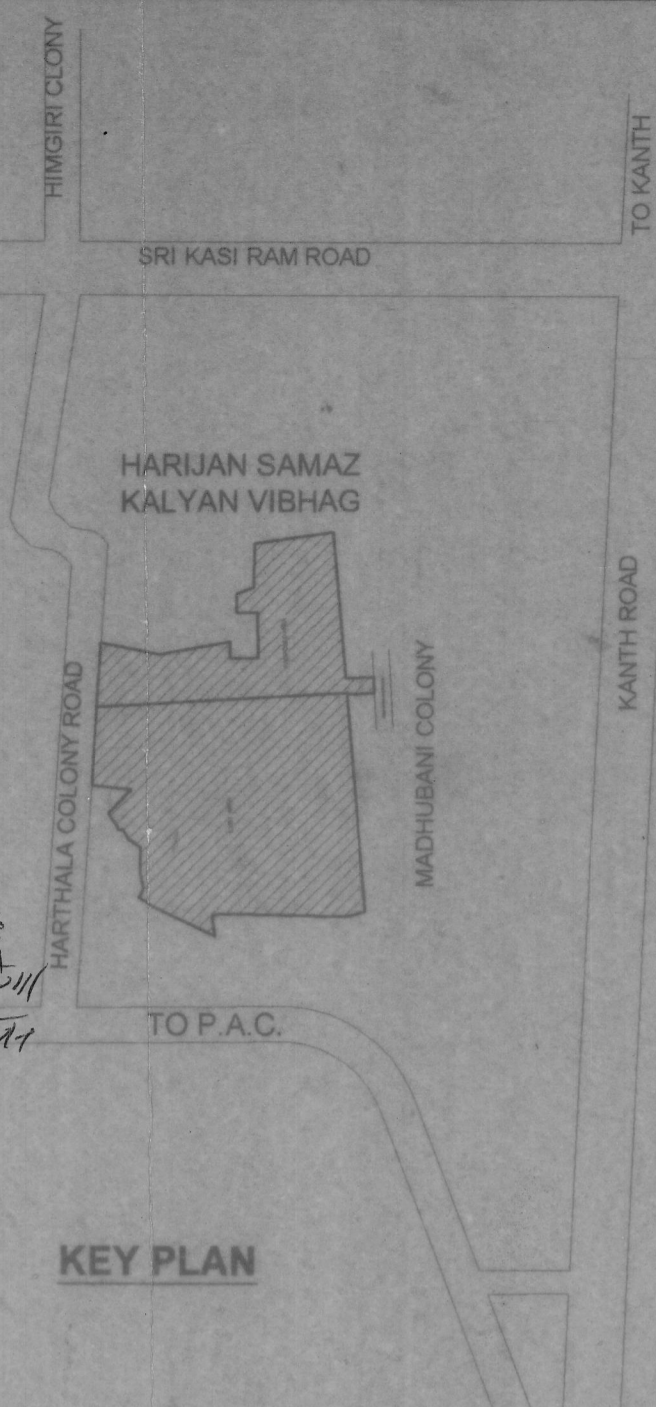

TOTAL PLOT AREA=4642.88 SQ.MT.

NO'S	PLOT SIZE	PLOT AREA (SQ.MT.)	NO'S	PLOT SIZE	PLOT AREA (SQ.MT.)
01	8.00X14.18	113.44	11	$\frac{(10.21+9.45)}{2} \times 13.06$	128.38
02	8.00X14.18	113.44	12	$\frac{(17.60+16.40)}{2} \times 9.80$	166.60
03	8.00X14.18	113.44	13	$\frac{(16.40+15.36)}{2} \times 8.84$	140.38
04	8.00X14.18	113.44	14	$\frac{(15.36+14.32)}{2} \times 8.84$	131.16
05	8.00X14.18	113.44	15		124.12
06	8.00X14.18	113.44	16	$\frac{(14.53+16.75)}{2} \times 8.84$	138.26
07	8.00X14.18	113.44	17	$\frac{(16.75+18.97)}{2} \times 8.84$	157.88
08	$\frac{(14.20+14.02)}{2} \times 8.00$	112.88	18		144.43
09	$\frac{(14.38+14.20)}{2} \times 8.00$	114.32			
10	$\frac{(14.38+14.46)}{2} \times 13.87$	200.14			
					2352.65

TOTAL LAND AREA =17000.00 SQ.MT.
 PROPOSED LAYOUT AREA =4642.88SQ.MT.
AREA STATEMENT OF PROPOSED

AREA OF LAYOUT	=4642.88SQ.MT. 100 %
AREA OF PLOTS	=2352.65SQ.MT. 50.67 %
AREA OF PARK	=703.06SQ.MT. 15.14 %
AREA OF ROAD	=1587.17 SQ.MT. 34.19 %

EXIST.PROPOSED SITE PLAN
 SCALE 1:700

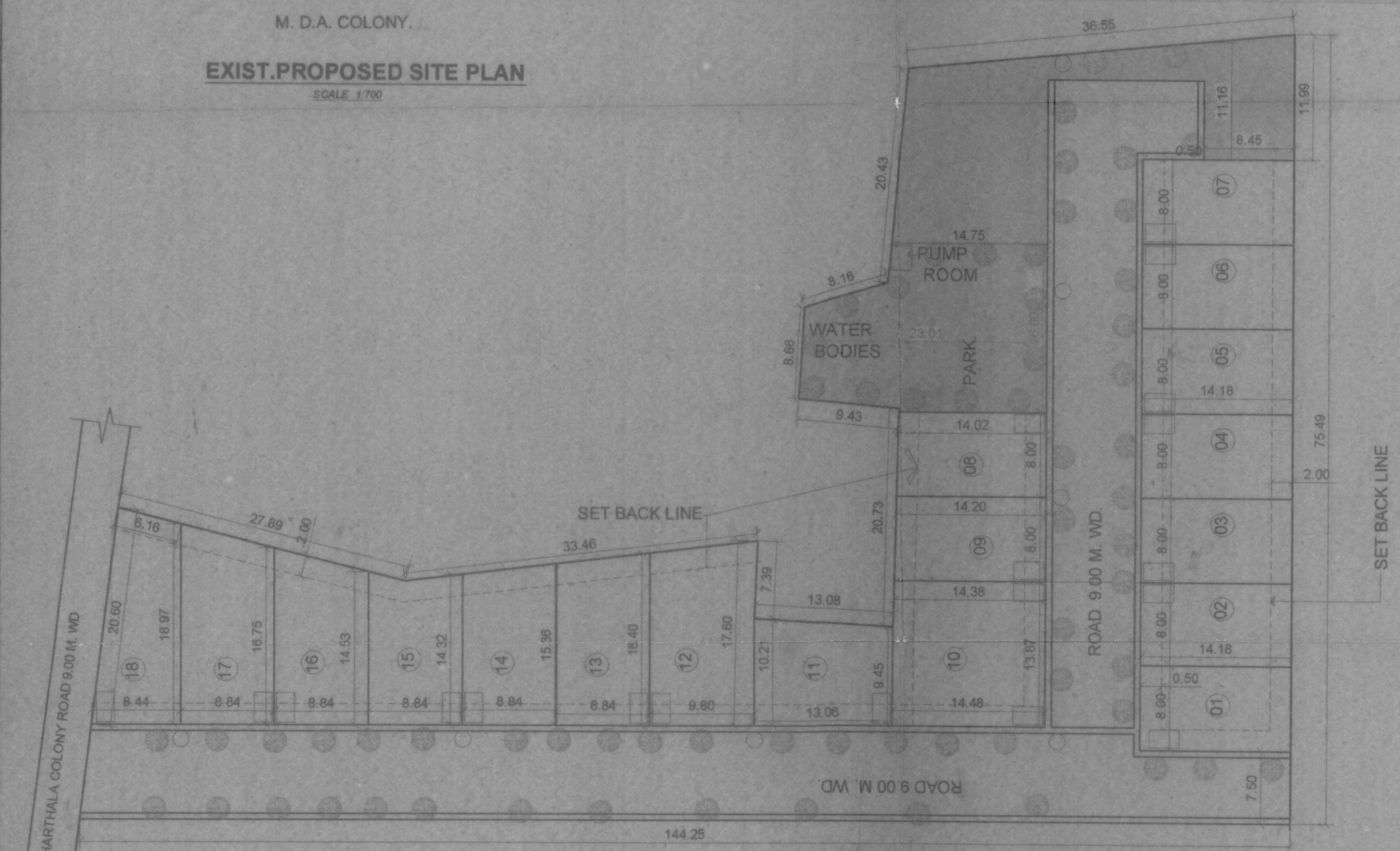

LAYOUT PLAN
 SCALE 1:400

LEGEND

- EXIST WORK (diagonal hatching)
- PROPOSED WORK (cross-hatching)
- SED BACK LINE (dashed line)
- DRAIN LINE (line with 'x' marks)
- WATER SUPPLY LINE (line with circles)
- ELECTRIC LINE (line with dots)
- TREE (circle with cross)
- ELECTRIC POL (circle with 'E.P.') (circle with 'E.P.') (circle with 'E.P.')

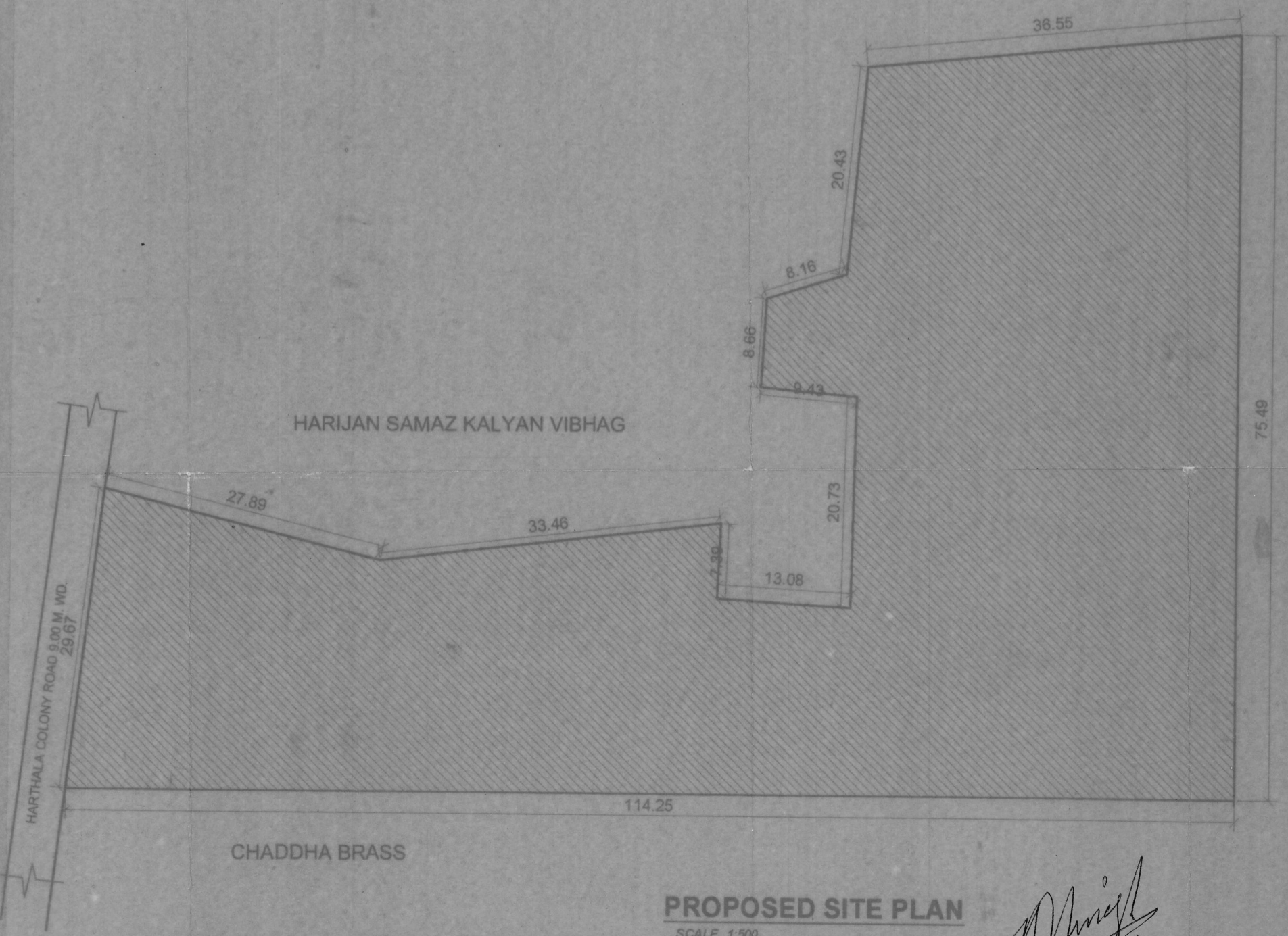

PROPOSED SITE PLAN
 SCALE 1:500

PROPOSED RESIDENTIAL LAYOUT PLAN FOR CHADHA BRASS LIMITED AT-VILL HARTHALA MORADABAD

DEALT BY	CHD BY
APP BY	DATE
LAYOUT PLAN	
DRG. TITLE	
DRG. NO.	ALT-01
SCALE	NORTH
R. K. MALIK & ASSOCIATES	
ARCHITECT - ENGINEER	
INTERIOR - EXTERIOR	
ENVIRONMENTAL CONSULTANT	
B. AVAS VIKAS MARKET, CIVIL LINES, PILLI KOTHI, MORADABAD	
PHONE : 2416764	

OWNER'S SIGN. *R. K. Malik*
 ARCHITECT SIGN. *R. K. Malik*